

# ARTISTS IN RESIDENCE 2027 HANDBOOK



**BUNDAON**

# CONTENTS

Welcome to Bundanon	1
First Nations	3
Accommodation & studios	5
Pre-arrival	9
Arrival & departure	10
Site & facilities	12
Access	14
What to bring	16
Communications	17
When you are here	19
Safety	21
Medical information	22
Evacuation plan	23
Contact list	24
In an emergency	25

WIDTHOUW (HELLO/WELCOME)

# WELCOME TO BUNDANON

Bundanon acknowledges the people of the Dharawal and Dhurga language groups as the traditional owners of the land within our boundaries, and recognises their continuous connection to culture, community and Country.



The Shoalhaven River, Bundanon. Video (still): MANA Creative.

*[Bundanon is] a special place of Aboriginal significance - where hinterland meets the coastal plain, where the saltwater meets the fresh, it's where our language groups - the Dharawal and Dhurga met, but most importantly it's where people would come and meet.*

– Noel Webster, Yuin Walbunja

Bundanon was created as an organisation to support creativity and learning in a unique cultural and natural landscape. It stretches across two sites along the Shoalhaven River.

Arthur and Yvonne Boyd's gift of Bundanon has given Australia a unique cultural and environmental asset. Born out of Boyd's often stated belief that you can't own a landscape', and the wish that others might also draw inspiration from this remarkable place.

The Artists in Residence program is the result of the Boyds' generous act, with the express aim that artists of all disciplines might experience the beauty of the Shoalhaven and be inspired to develop and make new work. We welcome approximately 350 artists to the residency program each year.

*".. A place for the community to enjoy the bush and the river, and a place to be used as a forum where those from every facet from the arts and sciences could get together."*

*Arthur Boyd*



# FIRST NATIONS

Bundanon acknowledges the Dharawal and Dhurga language-speaking peoples as the Traditional Owners of the land within our boundaries, and recognises their continuous connection to culture, community and Country.

Bundanon is deeply committed to supporting First Nations peoples, both those participating in the Artists in Residence program and those in the broader community.

## FIRST NATIONS ARTISTS

Your cultural safety during your residency at Bundanon is of utmost importance to us. To ensure this, we offer several supportive measures. These include organising a Welcome to Country ceremony conducted by a respected member of the local Indigenous community, and if needed, arranging for a member of your own community to provide additional support during your stay.

We encourage you to reach out to us to discuss any specific requirements or concerns you may have regarding cultural safety. If you prefer to speak directly with a First Nations staff member, please feel free to contact Bundanon's Cultural Liaison Manager.

## FIRST NATIONS ENGAGEMENT

Projects involving First Nations content or participants at Bundanon must engage with the relevant traditional custodians. In alignment with our commitment to respecting local communities, we aim to avoid placing undue pressure on them. Therefore, it is the artist's responsibility to conduct thorough research and engage appropriately with community members and organisations. This may include providing fair compensation where applicable.

## INDIGENOUS CULTURAL & INTELLECTUAL PROPERTY

Bundanon acknowledges the centrality and significance of Culture and Country in all First Nations practices and knowledge. This understanding extends to the importance of protecting this knowledge and ensuring it is passed on in the proper ways. In acknowledging this, Bundanon commits to respect and uphold Indigenous Cultural and Intellectual Property Rights (ICIP).

Bundanon asks artists to consider if their work incorporates, is sourced from, or refers to cultural heritage material and, if so, to seek the appropriate consent from the community custodians.

Bundanon expects residency participants to follow ICIP best practice as outlined by the [Arts Law Centre of Australia](#).

## DEFINITION OF ICIP MATERIAL

ICIP refers to all aspects of First Peoples' cultural heritage, including the tangible and intangible. Heritage comprises all objects, sites and knowledge, the nature or use of which has been transmitted or continues to be transmitted from generation to generation, and which is regarded as pertaining to a particular Indigenous group or its territory. The heritage of First Nations people is a living heritage, and includes, but is not limited to:

- a. any form of traditional knowledge (scientific, technical, ecological and ritual);
- b. literary, performing, musical and artistic works (including songs, music, dances, stories, ceremonies, symbols, languages, performance and designs);
- c. cultural objects (including, but not limited to arts, crafts, ceramics, jewellery, weapons, tools, visual arts, photographs, textiles, contemporary art practices);
- d. human tissues and remains;
- e. immovable sites of significance, sacred materials and information (including sacred/historically significant sites and burial grounds);
- f. documentation of Indigenous peoples' heritage in all forms of media such as films, photographs, artistic works, books, reports and records taken by others, sound recordings and digital databases.

## LOCAL COMMUNITY ORGANISATIONS

### Nowra Local Aboriginal Land Council

02 4423 3163

[www.alc.org.au/land\\_council/nowra/](http://www.alc.org.au/land_council/nowra/)

### Jerrinja Aboriginal Land Council

02 4447 4355

[www.alc.org.au/land\\_council/jerrinja/](http://www.alc.org.au/land_council/jerrinja/)

### Gadhungal Marring

Dharrawal Traditional Custodians

Gadhungal Marring is a local business providing Australian indigenous cultural programs, experiences, and training services across various sectors. Their offerings encompass tours, cultural workshops, dance sessions, and immersive experiences, all available for a reasonable fee.

[www.gadhungalmarring.com.au](http://www.gadhungalmarring.com.au)



# ACCOMMODATION & STUDIOS

## ARTISTS IN RESIDENCE COMPLEX

### WRITERS' COTTAGE

The Writers' Cottage is a self-contained cottage with two bedrooms (both with double beds), kitchen, bathroom, laundry facilities, and study. The study contains a large working desk and upright piano, this space is suitable for writing and research.

### MUSICIANS' COTTAGE

The Musicians' Cottage is a self-contained cottage featuring three bedrooms. The front and rear bedrooms are equipped with king-sized beds that can be divided into two single beds if required. The middle bedroom is furnished with a single bed. The cottage has a spacious living area, a dining space, a kitchen, two bathrooms, and a laundry.

The cottage includes a purpose-built, acoustically designed studio space at the rear, featuring a Yamaha baby grand piano that undergoes regular tuning. There is a gas BBQ available at the cottage. Please clean after use and let us know if the gas runs out.

### GONSKI APARTMENT

The Gonski Apartment has one bedroom with a queen-size bed, a living room, desk and a bathroom. The kitchen is shared with the Sherman Apartment.

### SHERMAN APARTMENT

The Sherman Apartment has two bedrooms (one queen-sized and one single bed), a living room and a bathroom. The kitchen is shared with the Gonski Apartment.

### BARN STUDIOS

Across the courtyard from the apartments is a barn that houses two studios separated by sliding doors. Both have sinks, worktables, chairs, and easels, and are suitable for any form of creative practice that needs space for messy work. They are less suitable for noisy work, as only a thin partition separates them from each other.

### FERN APARTMENT & STUDIO (ACCESSIBLE)

The Fern Apartment has one bedroom with a queen-sized bed, an accessible bathroom, and shares a kitchen with the Freedman apartment. Adjoining the apartment is a 42sqm studio with a sitting room, as well as a worktable, chairs, easel, and sink. The Fern Apartment is wheelchair accessible, noting that access into the apartment is via a threshold ramp and there is currently no wheelchair access onto the studio back deck. For those requiring specific measurements, such as doorway widths, floor plans can be provided upon request.

### FREEDMAN APARTMENT & STUDIO

The Freedman Apartment has one bedroom with a queen-size bed and a bathroom. Adjoining the apartment is a 34sqm studio with a sitting room, as well as a worktable, chairs, easel, and sink. The kitchen is shared with the Fern Apartment.

### DOROTHY PORTER STUDIO

The Dorothy Porter Studio is a stand-alone building specifically designed as a rehearsal space for dance and performance work. It is 6.3m x 11.6m with a fully sprung floor, 8m high ceiling and electric piano. This is a studio only, and there is no adjoining apartment to this space. The Dorothy Porter Studio shares a wall with the Silversmiths' studio.

### DOROTHY DWYER SILVERSMITHS' STUDIO

The Dorothy Dwyer Silversmiths' Studio provides all the necessary working conditions, equipment and tools for professional silversmiths or goldsmiths to pursue their practice. This is a studio only, and there is no adjoining apartment. A handbook detailing equipment and layout of the studio is available on request

# ART MUSEUM SITE

## BOYD EDUCATION CENTRE

The Arthur & Yvonne Boyd Education Centre is sometimes used for larger group residencies. The Centre has 16 twin rooms to accommodate a maximum of 32 people with shared bathrooms and toilets, with a large paved multi-purpose hall.

Designed by internationally celebrated Australian architect Glenn Murcutt in association with Reg Lark and Wendy Lewin, the award-winning Boyd Education Centre is a multi-use space. It hosts programs, special events for visitors, and is available for large group residencies, corporate functions, seminars, and conferences.

At the heart of the Centre is the glass-fronted hall overlooking the Shoalhaven River. The hall can accommodate up to 100 people for dining, music rehearsal and performance, workshops, lectures, and conferences. The main hall dimensions are 18m x 9m. The floor surface is pavers and may not be suitable for high-impact physical activity. Optional flooring can be discussed for performance-based residencies with the Curatorial and Learning staff.



# ARTISTS IN RESIDENCE COMPLEX MAP

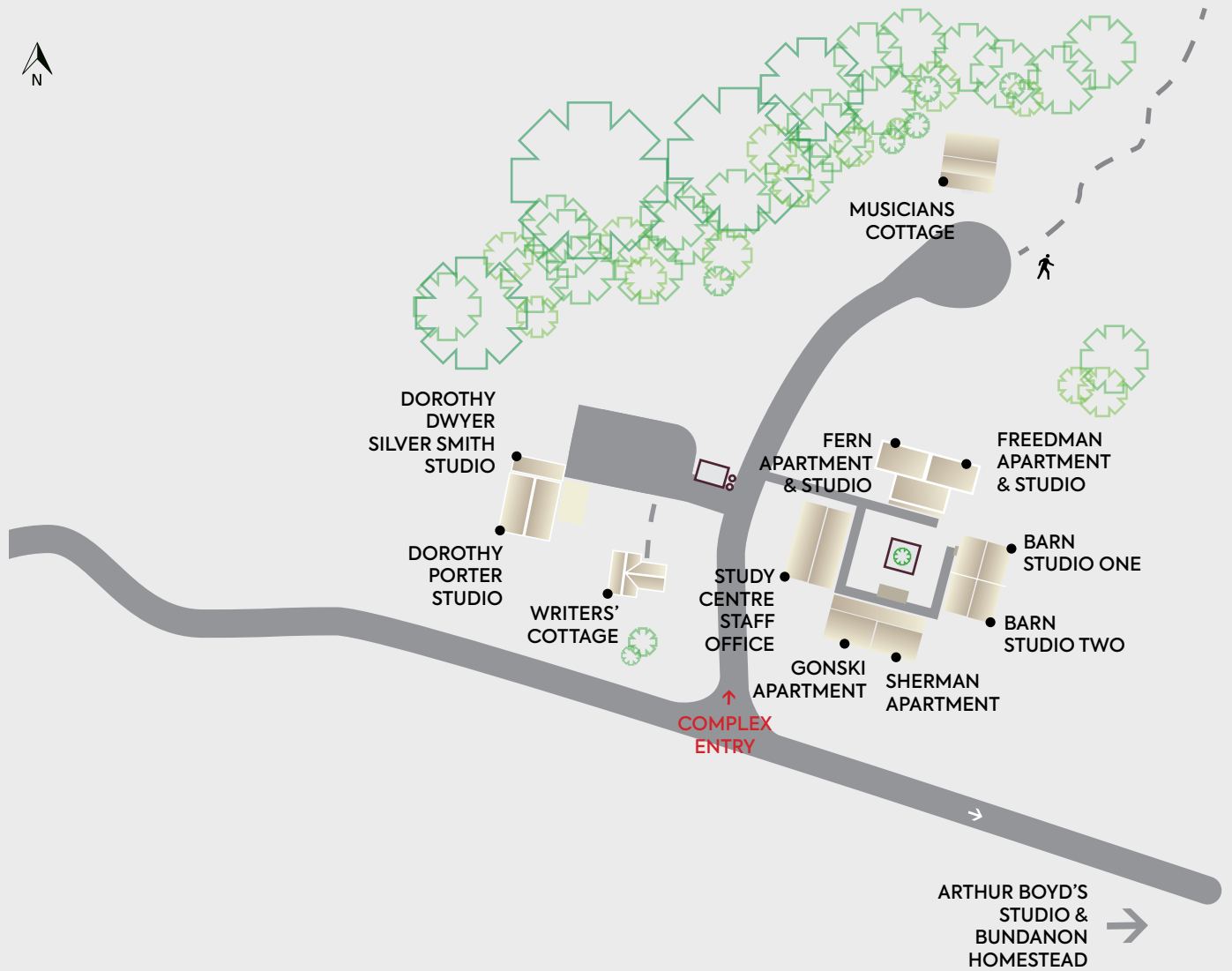



# PRE-ARRIVAL

## AGREEMENT & BOND

You will have signed an agreement before arriving on site at Bundanon, and paid a bond. All details of the residency will be put in writing between Bundanon and the resident artists.

## EXPECTATIONS

There are no required outcomes from your time in residence. All artists are expected to be independent and self-manage their equipment and supplies.

## PRE-ARRIVAL INFORMATION

To ensure your safety on site, all residents, visitors and guests are required to provide Pre-Arrival Information which details your next of kin, medical issues and emergency contacts. You will be prompted to do this via email and all information provided will be kept confidential.

## NO PETS

Pets are not permitted on site. The Bundanon properties are wildlife refuges, surrounded by substantial areas of natural bush supporting many threatened native species. Frequent fox baiting is in practice and bush ticks are a common risk to domestic animals.

Guide dogs and assistance animals are allowed on Bundanon properties. For individuals who require an assistance animal, it is important to notify us in advance to ensure that necessary accommodations can be made. We may request reasonable proof that your animal is a genuine assistance animal as noted above Bundanon is a wildlife refuge.

## VISITORS & GUESTS

Visitors, including the children and partners of resident artists, are not permitted to stay on the Bundanon properties. This is in adherence with risk management policies including those related to work health & safety (WHS), Bundanon's Child Safe Policy, and COVID management policy.

Due to the remote location, bushland environment, working farm, and working studios, there are inherent risks onsite that make the Artists In Residence complex unsuitable for children.

Bundanon is a place of creative work and reflection and consideration of all artists working on site is paramount.

## CLIMATE

The Shoalhaven area generally has a mild climate, but temperatures in winter occasionally reach zero at night and in summer often go above 30°C. You should bring clothes appropriate to the season. When outdoors in summer, wear sunscreen to avoid sunburn, wear a hat and drink plenty of water.

# ARRIVAL & DEPARTURE

## LOCATION

Artists are required to have their own vehicle or arrange transport. The residency complex is in an isolated location and Bundanon does not provide transport for artists whilst in residence. The residency site is approximately a 30-minute drive from the nearest town and 20 minutes from the Bundanon offices, noting that it is not walkable.

## ARRIVAL MONDAY 2PM - 4PM

Arrival is strictly between 2-4pm on Monday. Arrivals are after 2pm to allow for cleaning times between residencies. Please be advised that arrival is not permitted after 4pm as the roads become dangerous due to wildlife and the site will not be staffed. Artists arriving after 4pm will be responsible for arranging and paying for alternative accommodation. In the event that you are delayed, please contact us immediately by calling 02 4422 2123 or emailing [artists@bundanon.com.au](mailto:artists@bundanon.com.au)

## INDUCTION

On arrival, you will be given a detailed induction and safety briefing. All artists are required to attend the induction.

## DEPARTURE SUNDAY 10AM

Please depart your residence no later than 10am on the morning of your departure.

## DIRECTIONS

The Artists in Residence Complex is located at 533 Bundanon Road, Illaroo, NSW. The Boyd Education Centre and The Bridge are located at 170 Riversdale Road, Illaroo, NSW. Please observe speed signs and be careful of wildlife when travelling on our unsealed roads. Use the exact address on your GPS, Google, or Apple maps.

## DIRECTIONS FOR THE ARTISTS IN RESIDENCE COMPLEX

Once on Illaroo Road, continue until you see the large sign to Bundanon

- Turn LEFT to stay on Illaroo Road.  
Do not continue straight as this becomes Bugong Road
- Approximately 500 metres later, you will come to the first red Bundanon sign
- Turn RIGHT to continue on Illaroo Road towards the Homestead and Artist in Residence Complex
- Continuing on an unsealed road, following the intermittent red signs to Bundanon – it is a 9km drive. Along this stretch of road, Illaroo Road becomes Bundanon Road
- As you drive alongside the river, you will pass a machinery shed on your right and cleared farm
- Continue on for 200m and turn left at the rise of the hill to arrive at the Artists in Residence Complex



## TRANSFERS

On occasion transport to and from the residency complex may be arranged for up to 4 artists maximum at the beginning and the end of the residency period only. Artists are required to contact Bundanon staff at least 1 month prior to their residency date to discuss a request, noting that incoming and outgoing transfers are only offered on Mondays.

If transport is approved, artists are required to arrive at Bomaderry Train Station or Nowra (Stewart Place) bus terminal between 10am and 12.30pm on the Monday that their residency commences. Bundanon will transfer residents from the residency site on Mondays only.

## PLANNING YOUR TRIP

### Live Traffic NSW

News of incidents and conditions that affect your journey in Sydney and regional NSW.  
[www.livetraffic.com](http://www.livetraffic.com) or download the Live Traffic app to your phone.

### Transport NSW

24/7 trip planning information and live timetable information for rail, bus, ferry, road services.  
[www.transportnsw.info](http://www.transportnsw.info) or call 131 500.

A list of trip planning apps can be found here;  
[www.transportnsw.info/apps](http://www.transportnsw.info/apps)

### Avis & Budget Car Hire

Corner Bolong Road & Beinda Street  
(+61) 0447 267 975  
[www.avis.com.au](http://www.avis.com.au)

### Nowra Taxis

Phone 02 4421 0333. A taxi between Nowra and the Bundanon residency site is approximately \$80 one way.

Please note that Bundanon does not cover your travel expenses.

## MAP TO BUNDANON

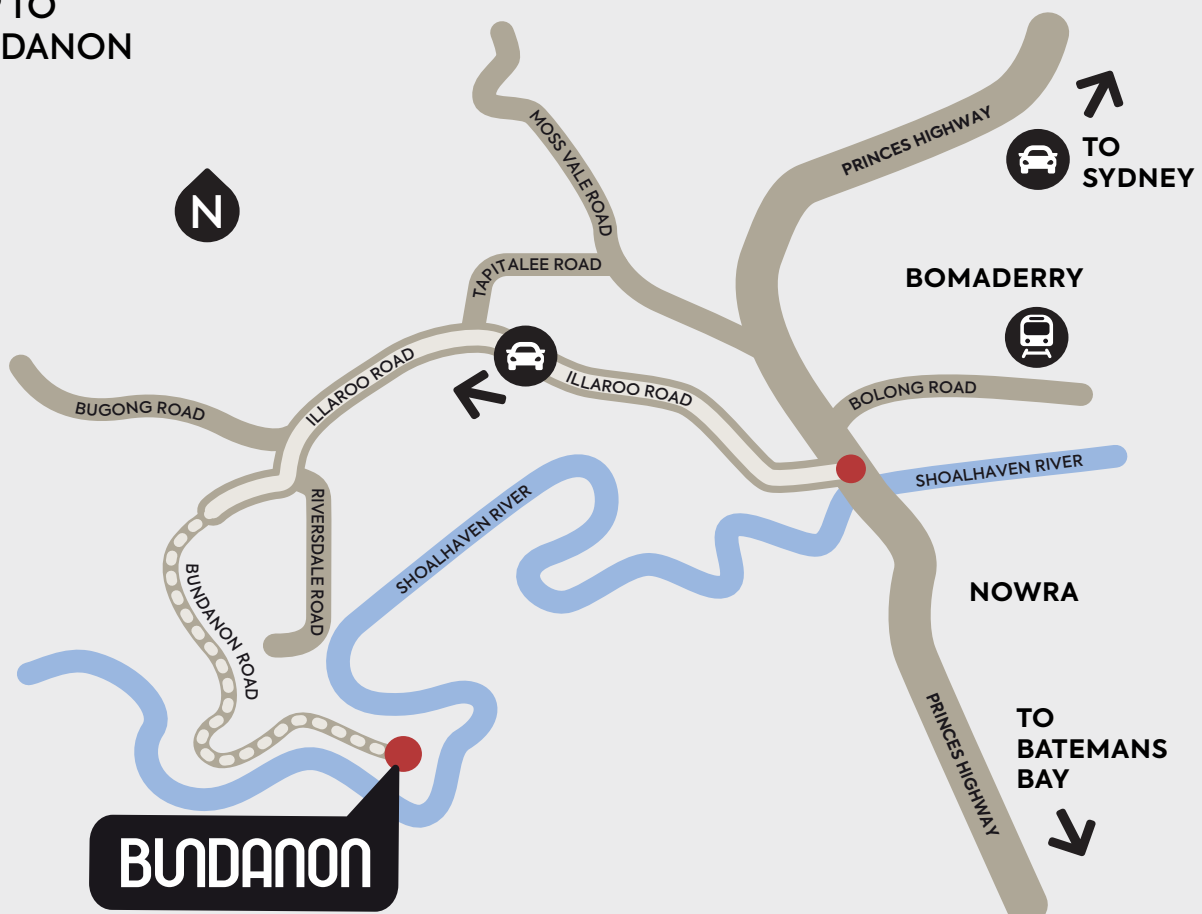

# SITE & FACILITIES

## MATERIALS & EQUIPMENT

You will need to bring all your own materials and equipment.

## OTHER RESIDENTS & SHARED SPACES

Please be considerate of other residents on site. Keep noise-generating activities to a reasonable level. Respect the privacy of other residents, particularly in communal spaces. Be mindful in the shared kitchens and ensure you clean up after yourselves promptly, and do not enter living or studio spaces without their permission.

If you are having any communication issues with other residents or feel uncomfortable about another resident's behavior, please inform the Curatorial and Learning staff as soon as issues arise.

There is one bathroom per residence. Bathrooms will only need to be shared if there is more than one person staying in each residence.

## LAUNDRY FACILITIES

The Writers' Cottage has a washing machine located in the bathroom. The Musicians' Cottage has a laundry with washing machine and dryer. The Fern and Freedman apartments share a washing machine located in the Fern bathroom. The Gonski Apartment and Sherman Apartment share a laundry with washing machine and dryer, located off the kitchen.

## SOLAR POWER & WATER TANKS

As part of its greening program, Bundanon has installed solar panels on the roofs of the Artists in Residence accommodation. All residences have reverse cycle air conditioning units. All water in the residency complex is potable water. Artists should be mindful of power and water usage. Please turn off appliances and air conditioners when not in use, and close external doors and windows while the air conditioning is in use.

## SMOKING

There is no smoking in all the accommodation, living areas and studios. No smoking in the Artists in Residence Complex courtyard. Please place cigarette butts in the outside bins, not on the ground. If you wish to smoke, please do so at least 20m from buildings.

## ENVIRONMENT

The Bundanon properties are wildlife refuges, surrounded by substantial areas of natural bush supporting many threatened species. Please be mindful and do not approach, disturb, or feed the wildlife. We ask you also to take care driving. We have carers from local wildlife groups who come on site after hours to attend to sick or injured wildlife.

## PEST MANAGEMENT

Part of the care of the Bundanon Collection and Heritage Precinct is to guard against possible rodent and insect activity. Please do not leave food out or garbage uncovered as it will attract rodents and other pests. Please be mindful of rodent bait stations located around the property outside of buildings as they contain poison and should not be handled.



# ACCESS

Bundanon's commitment to accessibility extends to both our Artists in Residence program and Complex. We endeavor to accommodate all requirements to the best of our ability.

While we strive for accessibility, it is important to note that certain features of the site may present challenges, such as uneven terrain and steps both internally and externally.

The Fern Apartment and Studio are wheelchair accessible. Access is facilitated through a ramp from the designated parking area to the apartment, noting access into the apartment is via a threshold ramp. The connecting studio and bathroom are fully accessible, however access to the studio deck is currently not wheelchair accessible. The communal quadrangle situated close to the Fern apartment and studio is wheelchair accessible. For those requiring specific measurements, such as doorway widths, floor plans can be provided upon request.

We recognise the importance of individualised support and will collaborate closely with you to develop a tailored access plan if needed. This support may encompass assistance with sourcing provisions such as Auslan interpretation, captioning services, or accommodating the attendance of a support worker or carer during the residency, noting that residents are required to cover costs for some services. Assistance animals are welcome, and we can offer guidance to ensure their readiness for your stay. We may request reasonable proof that your animal is a genuine assistance animal as Bundanon is a wildlife refuge.

Our approach is centered around the individual, aiming to cultivate an environment that is not only accessible but also inclusive, and culturally sensitive for all participants.

We encourage you to reach out to us to discuss your access needs or any concerns you may have regarding access by emailing [artists@bundanon.com.au](mailto:artists@bundanon.com.au) or calling 02 4422 2123





# WHAT TO BRING

## FOOD

All artists look after their own food needs including condiments while in residence. Bundanon provides all linen, hand soap, towels, and toilet paper.

Larger groups will be given contact details for local caterers or there is a fully equipped commercial kitchen for self-catering that can be booked with advanced notice.

There are large supermarkets, butchers, fishmongers, and grocers in Nowra. There is also a smaller shopping centre, with a small supermarket, pharmacy, butcher, and hairdresser, at North Nowra (a little closer to Bundanon). Bundanon is 30 minutes from the nearest shops or restaurant. A list of shops and suppliers is included at the end of this handbook.

If Bundanon has agreed to provide a transfer, artists will be required to do an online shop at Woolworths Bomaderry. Staff will drive you from the train station or bus stop to Woolworths Bomaderry to pick up your online order of groceries (Woolworths Click & Collect) on the day of your arrival and will collect online grocery orders on your behalf once per week thereafter if arranged by Friday

## LINEN & CLEANING

Clean linen and towels are supplied by Bundanon. A kitchen and bathroom cleaning service and fresh linen is provided from 10am Mondays for residents staying more than 1 week. Housekeepers are not responsible for cleaning your bedroom or studio. Please make the apartment available for this service. If you are not in your apartment housekeeping will enter.

## LAUNDRY

All accommodation areas have access to a washing machine. You will need to provide your own washing powder.

## COOKING

All residents must provide their own food including condiments. All residences have fully equipped kitchens with cookware, crockery, and cutlery. The Fern and Freedman apartments share a kitchen, as do the Sherman and Gonski. Please be mindful of your fellow resident and wash dry and put away your dishes, keep the benches clean and remove your rubbish promptly.

An electric BBQ is available for use in the shared quadrangle. Please clean after use.

## Ovens

The ovens in the kitchens need to have the time set to work. Correct time is not important.

To set the time: Push the 2 buttons on the top left at the same time (hold them in) then push the + or - button to set clock. Following any power shortages, you may need to re-set the time for your oven to work.

## RUBBISH REMOVAL

Each apartment has its own bin. Please be responsible for emptying these bins into the large bins (located in car park of artists-in-residence complex). Please try to recycle your paper, plastic, bottles, and tins in the recycling bins adjacent to the car park. Please note that there is no compost due to prevalent wildlife and their safety.

## END OF RESIDENCY

Please ensure that all rubbish is removed, including the kitchen bins, and that no food is left in the kitchen cupboards and fridges.

**PLEASE NOTE:** Painting or drawing directly on to walls is not permitted unless you are prepared to re-paint the entire wall back to its' original colour at your own expense.

# COMMUNICATIONS

There is very limited mobile phone coverage at the Artist in Residence complex.

Wi-fi is available in the Artist in Residence complex buildings and residents can use communication apps to make external calls on their digital devices (e.g., wifi calling, Signal, WhatsApp etc.). All use of the Internet must be in compliance with Australian law.

All Bundanon residences have telephones. You are welcome to provide the direct number of your residence phone to your contacts so they can call you.

LOCATION	EXTENSION	DIRECT NUMBER
Fern Apartment & Studio	906	02 4422 2196
Freedman Apartment & Studio	911	02 4422 2191
Sherman Apartment	914	02 4422 2194
Gonski Apartment	908	02 4422 2197
Barn Studios	913	02 4422 2193
Writers' Cottage	907	02 4422 2197
Musicians' Cottage	917	02 4422 2917
Dorothy Porter Studio	912	02 4422 2912
Dorothy Dwyer Silversmiths' Studio		
Study Centre	910	02 4422 2910

The telephones in the Artists in Residence Complex rely on Voice over Internet Protocol (VoIP) technology and will not function if there is a failure in the Internet connection.

In the event of an internet failure, a satellite phone is available in a bright orange case located on the post outside the Study Centre. The case contains the phone, a charger, and a quick start guide. The phone is equipped with an SOS button on the top right-hand side, which directly calls 000 when activated.

## MAILING ADDRESS

If you need to receive mail or packages, please use the address below. Please be aware that the Bundanon staff check the PO box periodically, and once your mail arrives, you will be notified to collect it from the Information Office at the Art Museum:

(Your name)

Artists in Residence Complex  
Bundanon  
PO Box 3343  
North Nowra NSW 2541  
Australia

## SOCIAL MEDIA

We are interested in what Bundanon's resident artists are working on during their residency. We invite you to share your experience and work with the following handles and tags:

Instagram                    @bundanontrust

Tags                            #bundanon #bundanonresidency

Facebook                    facebook.com/bundanon



FRAGILE

# WHEN YOU ARE HERE

Bundanon has a dynamic and ongoing cultural program that stretches across the two sites. The program includes cultural walks, live events and talks.

The Bundanon Homestead and Arthur Boyd Studio, gardens and walking tracks are open to the general public Saturday and Sunday from 10am to 4pm. Homestead Cafe is open Saturday and Sunday 10am–3pm.

The Art Museum (located on our other site) is open Wednesday through to Sunday from 10am to 4pm. The Ramox Cafe is open Wednesday to Sunday 10am to 4pm.

As a resident at Bundanon you are welcome to walk the property whilst here and have free entry to the Art Museum, Homestead and Studio. Just let the Front of House staff know the day of your visit.

You are also welcome to discounted tickets on our Public Programs of live events and workshops. Please see the What's On section of our website and contact us at [artists@bundanon.com.au](mailto:artists@bundanon.com.au) so we can arrange registration.

## LOCAL SHOPS AND SUPPLIERS

### Nowra Fresh

Fish and meat market  
2 East St, Nowra  
[nowrafresh.com](http://nowrafresh.com)  
02 4429 1900

### Nowra Farmers Market

Fresh vegetables and delicatessen  
111 North St, Nowra  
(Located in the car park behind Nowra Fresh)  
[nowrafarmersmarket.com.au](http://nowrafarmersmarket.com.au)  
02 4422 3356

### Woolworths Bomaderry

320 Princes Highway, Bomaderry  
[woolworths.com.au](http://woolworths.com.au)  
02 4448 2512

### The Friendly Grocer

6 McMahons Rd, North Nowra  
(North Nowra Shops)  
02 4421 6000

### Coles

Cnr Kinghorne & Junction St, Nowra

### ALDI

54 Narang Road, Bomaderry  
8-16 Kinghorne Street, Nowra

### Hyper Hyper Coffee

85 North St, Nowra  
[hyperhypercoffee.com.au](http://hyperhypercoffee.com.au)

### Flame Pizza

13/9 McMahons Rd, North Nowra  
(North Nowra Shops)  
[flamepizzeria.com.au](http://flamepizzeria.com.au)  
02 4423 7777

### Good Things Organic

2/62 North St, Nowra  
02 4422 4402  
(store entry from Egans Lane Carpark)  
[goodthingsorganic.com.au/](http://goodthingsorganic.com.au/)

### Deli on Kinghorne

84 Kinghorne St, Nowra  
[thedeli.net.au](http://thedeli.net.au)  
02 4423 7556

### The Tea Club

46 Berry St, Nowra  
02 4424 0120

### Hunt & Gather

32 Berry St, Nowra  
0412 079 171

### Blak Cede Gonyah Cafe + Shop

39A Kinghorne Street, Nowra  
02 4413 2500  
[blakcede.com.au](http://blakcede.com.au)

## USEFUL SHOPS

### Arthouse Direct

Art supplies  
(Woolworths Carpark),  
6/68 North St, Nowra  
arthousedirect.com.au  
02 4421 6821

### The Photo Place

Photographic supplies  
Shop 8, Morrisons Arcade  
111 Junction street, Nowra  
thephotoplace.com.au  
02 4421 6484

### Bunnings Warehouse

Hardware  
147 Princes Hwy, South Nowra  
02 4423 8100

### South Coast Music

Shoalhaven Arcade, 19 Kinghorne St, Nowra  
scmusic.com.au  
02 4421 8688

### Dean Swift Books

120 Junction St, Nowra  
deanswift.com.au  
02 4454 5568

### Dymocks Books

68 Kinghorne St, Nowra  
02 4421 8699

### Officeworks

Stationery and Electronics  
1 Haigh Ave, Nowra  
02 4428 9800

### Harvey Norman

Electronics and appliances  
193 Princes Hwy, South Nowra  
02 4421 1300

### Spotlight

1/28 Central Ave, South Nowra  
02 4480 7103

### Nowra Electronics

Electronic and photographic supplies  
44 Berry Street, Nowra NSW 2541  
nowraelectronics.com.au  
02 4423 0642

## LOCAL CULTURAL ORGANISATIONS

### Shoalhaven Regional Gallery

12 Berry St, Nowra  
shoalhavenregionalgallery.com.au  
02 4429 5444

### Nowra Library

10 Berry Street, Nowra  
shoalhavenlibraries.com.au  
02 4429 3705

### Meroogal

Cnr West & Worrigea St, Nowra  
sydneylivingmuseums.com.au/meroogal  
02 4421 8150

### Jervis Bay Maritime Museum & Gallery

Woollamia Rd, Huskisson  
jervisbaymaritimemuseum.asn.au  
02 4441 5675

### Aboriginal Land Council

59 Beinda St, Bomaderry  
02 4423 3163

### Roxy Cinema

41 Berry St, Nowra  
roxy.com.au  
02 4423 5222

### Shoalhaven Entertainment Centre

42 Bridge Rd, Nowra  
shoalhavenentertainment.com.au  
02 4429 5757

# SAFETY

## EXTREME WEATHER EVENTS AND BUSHFIRES

The residency program may be adjusted in response to severe weather events to ensure the safety of all artists and staff. Evacuation and cancellations may be necessary during extreme weather conditions or in the case of a Catastrophic Rating issued by the NSW Rural Fire Service (RFS), especially when access to the properties is dangerous or limited. Bundanon will instigate communication in these situations. It is crucial that you await our instructions and refrain from attempting to exit without full knowledge of the conditions. To stay informed about bushfires in the local area, you can use the NSW RFS FIRES NEAR ME app.

## BUSH WALKING AND WALKING TRACKS

There are two walking tracks on the site: the Haunted Loop and the Treelines Track.

If you decide to go bushwalking, it is crucial to inform someone about your plans, specifying which track you will take and how long you expect to be on it. If direct communication is not possible, leave a note on your refrigerator with these details. This precaution is particularly important during bushfire season.

Dress appropriately for the weather, wear sturdy enclosed footwear, a hat, sunscreen, and insect repellent, and take a bottle of water. Stick to the formal walking tracks as marked on the site, and ideally, walk with a companion. Avoid walking in severe weather conditions, such as extreme heat or high winds and watch for wombat holes.

Access to the river can be made via the Treelines Track by Janet Laurence (indicated on the Bundanon Walking Tracks map). We ask you to please leave gates as you found them, when using this track.

## BITES AND STINGS

There are snakes, spiders, mosquitoes, bats and ticks at Bundanon. To prevent being scratched or bitten, please wear appropriate clothing when bush walking and always wear shoes when outside. Do not approach or touch wildlife.

## FIRE HAZARDS

You should acquaint yourself with fire evacuation procedures and, if in doubt, contact a staff member.

Please do not leave any flammable fluids or materials in common areas and ensure that any such materials are safely stored in your studio. You must not block passageways or other common areas with artworks or materials. Campfires are not permitted.

# MEDICAL INFORMATION

## HOSPITALS

### Emergency Department

Shoalhaven District Memorial Hospital

Shoalhaven St, Nowra

(ER entrance Scenic Drive)

[islhd.health.nsw.edu.au](http://islhd.health.nsw.edu.au)

02 4421 3111

## DOCTORS

### Nowra Medicare Urgent Care Clinic

107 Scenic Dr, Nowra NSW 2541

Inside Grand Pacific Health Centre – Nowra

Open 8am–10pm

Bulk Billed, Walk-Ins

02 4448 2240

[NowraUCC@gph.org.au](mailto:NowraUCC@gph.org.au)

### Grand Pacific Health

107 Scenic Drive, Nowra

(Next to Shoalhaven Hospital)

02 4448 2255

### North Nowra Medical Practice

(This practice does not bulk bill)

23 McMahons Rd, North Nowra

02 4423 5991

### Meroo Street Family Practice

(This practice bulk bills in some instances)

1 Meroo St, Bomaderry

02 4421 4655

## PHARMACIES

### North Nowra Amcal Pharmacy

North Nowra Shopping Centre

McMahons Rd, North Nowra

02 4421 5100

### Bomaderry Pharmacy

37 Meroo St, Bomaderry

(opp. Train station)

02 4421 2736

### Choice Pharmacy

320 Princes Hwy, Bomaderry

02 4421 0524

### Chemist Warehouse

83 to/87 Junction St, Nowra

02 8381 4526



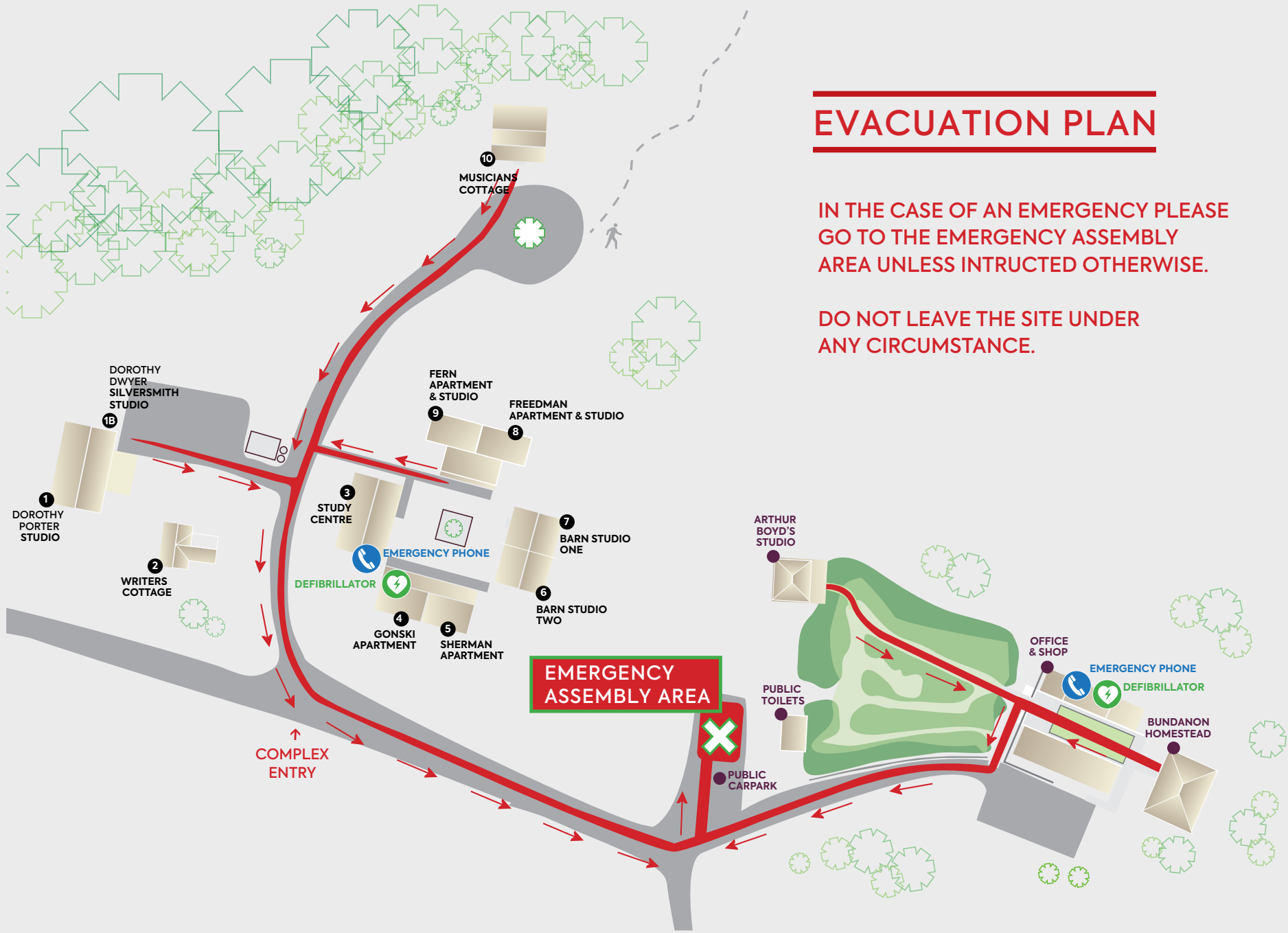

# EVACUATION PLAN

IN THE CASE OF AN EMERGENCY PLEASE GO TO THE EMERGENCY ASSEMBLY AREA UNLESS INTRUCTED OTHERWISE.

DO NOT LEAVE THE SITE UNDER ANY CIRCUMSTANCE.

# CONTACT LIST

**IN CASE OF AN EMERGENCY CALL 000**

## BUNDANON CONTACT LIST (DURING OFFICE HOURS)

CONTACT	EXTENSION	DIRECT NUMBER
Visitor Services Office	100	02 4422 2100
Artist Residency Program – Jane Pollard	123	02 4422 2123

## AFTER HOURS CONTACT LIST

If you need assistance out of office hours, please use the on-call number below.

**ON-CALL 02 4422 2112**

If you cannot reach anyone, please contact staff in the order below until you speak to an actual person.

CONTACT	DIRECT NUMBER
Caretaker and Deputy Chief Warden – John	0412 245 341
Operations Manager and Chief Warden – Simon Maberley	0409 559 171

## ARTISTS IN RESIDENCE COMPLEX CONTACT LIST

LOCATION	EXTENSION	DIRECT NUMBER
Fern Apartment & Studio	906	02 4422 2196
Freedman Apartment & Studio	911	02 4422 2191
Sherman Apartment	914	02 4422 2194
Gonski Apartment	908	02 4422 2197
Barn Studios	913	02 4422 2193
Writers' Cottage	907	02 4422 2197
Musicians' Cottage	917	02 4422 2917
Dorothy Porter Studio	912	02 4422 2912
Dorothy Dwyer Silversmiths' Studio		
Study Centre	910	02 4422 2910
Satellite phone (outside Study Centre)		0147 168 630

# IN AN EMERGENCY

## IN CASE OF AN EMERGENCY CALL 000

Dial 000 if medical or other emergency, then notify a member of Bundanon staff.

Address: 533 Bundanon Road, Illaroo, NSW

Nearest cross street: Hughes Road Distance: 7km

GPS coordinates: -34.888850, 150.500102

### DIAL 000 IF MEDICAL OR OTHER EMERGENCY

During an emergency you must follow the instructions of Bundanon staff.

You will be instructed on how and when to exit if necessary. If staff are not on site when an emergency becomes apparent, proceed to the emergency evacuation assembly area, as indicated on the evacuation plan and during your induction.

### EMERGENCY KITS

Emergency kits are located on top of the fridge in each residence and are replenished regularly. They include:

- First Aid kit
- Snake bite kit
- Tick kit
- Blackout kit

### POWER FAILURE

In the event of a power failure, several services will be affected, including Wi-Fi, phones, and water.

Both the Wi-Fi and phone systems have backup batteries that will last for a limited time. Once these batteries are depleted, communication will rely solely on mobile phones, depending on reception. You may need to move around the property to find a signal, though mobile reception is typically available near the entrance of the Artists in Residence Complex, close to the large rocks and sign. We recommend keeping your personal phones, devices, and laptops charged throughout your stay. In case of an emergency, a satellite phone is available outside the Study Centre.

Water tank pumps will also stop working, limiting access to water for bathroom and kitchen use. Please ensure the provided water jug in the fridge is kept full for drinking water. If it runs out, you can use the emergency water supply located on top of the fridge. Additional water can be accessed from a tap on the water tank behind the Dorothy Porter Studio. Extra toilets are available adjacent to Arthur Boyd's Studio. Each kitchen has an emergency blackout kit on top of the fridge, containing torches, lanterns, candles, and matches.

The stove in the Musicians' Cottage runs on gas and can be used for cooking during a power failure and there is a gas BBQ available behind the Musicians' Cottage.

